

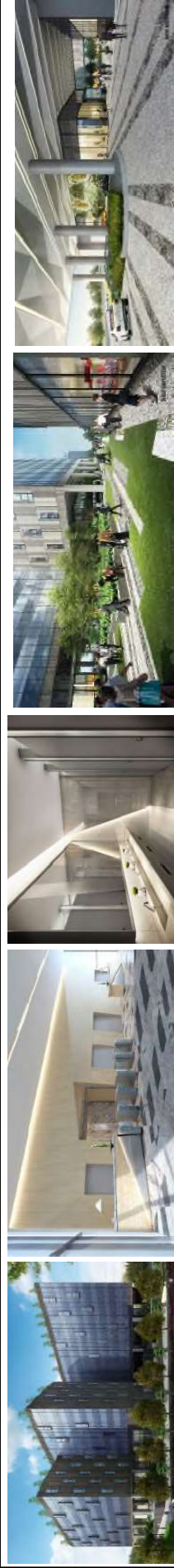

**Solaris @ Kallang 164**



|                 |                         |                           |   |   |   |
|-----------------|-------------------------|---------------------------|---|---|---|
| Location        | Zone / Description      | Sizes Available (approx.) | Specifications  | Factsheet   | Contact Person(s)   |
| 164 Kallang Way | Business 2 - High specs | 2,275 sqft to 35,800 sqft | <ul style="list-style-type: none"> <li>- Brand new B2 High Specs space</li> <li>- City fringe, direct access from PIE and 7 minutes walk to Geylang Bahru MRT station</li> <li>- Air-con foodcourt</li> <li>- Smart lift system complete with secured access</li> <li>- Centralised chilled water system</li> <li>- Production/Lab units</li> </ul> |  | <p>Xue Ling<br/>8511 7113</p> <p>Sarah Shah<br/>9652 4479</p> |

UNIT AVAILABILITY

|   |            |         |                           |   |                           |                |                           |  |
|---|------------|---------|---------------------------|---|---------------------------|----------------|---------------------------|--|
| Floorplans  | Storey     | Unit No | Lettable Area (sqft)      | Floor Loading                                   | Floor-to-Floor Height (m) | Date Available | Asking Rental (psf / mth) | REMARKS  |
|  | 2nd to 7th | -       | 2,275 sqft to 35,800 sqft | 7.5 kN/m <sup>2</sup> to 10.5 kN/m <sup>2</sup> | 4.9 m to 9.8 m            | Immediate      | \$4.20 to \$4.60          | <p><b>3 months' commission for 3 years' lease term</b></p> |